



---

# GATE STREET

A UNIQUE VENUE NESTLED IN THE SURREY HILLS

CORPORATE EVENTS  
& HOSTING

---

EAT | WORK | PARTY | SLEEP





# GATE STREET

OUR UNIQUE VENUE	4
OUR SPACES	8
OUR SITE PLAN	12
OUR ACCOMMODATION	14
FILMING AT GATE STREET	18
YOUR EVENT	22
YOUR WELLNESS	26
TEAM BUILDING	30
OUR SUPPLIERS	34
HOW TO FIND US	36



# OUR UNIQUE VENUE

---

## AN INSPIRING COUNTRYSIDE LOCATION

Gate Street is an ideal location for all your corporate and hosting needs. Just 20 minutes from the centre of Guildford, a short journey from Waterloo, our regenerative farm allows for an escape from city life. Gate Street is a family run farm & events venue which is located in the outstanding Surrey hills amongst bluebell woods and rolling fields.





FARMLAND LOCATIONS



PRIVATE EVENTS



MINDFULNESS



CORPORATE MEETINGS



TEAM BUILDING



CHARITY EVENTS

## ESCAPE THE DAILY GRIND FOR THE TRANQUIL COUNTRYSIDE

Gate Street Barn is famed for its weddings, however it is also a fabulous location for all other events and celebrations. Our picture-perfect venue will have all your guests enthralled and planning their next visit. We are here to help every step of the way and we have a number of recommended suppliers who will ensure your day is exactly as you envisioned it to be. The layout of the venue means you can have an intimate event or a lavish celebration in stunning surroundings.







## OUR SPACES

### OUR DIVERSE VENUE ALLOWS YOU TO OPTIMISE YOUR DAY

Choose from our traditional Barn which seats up to 150 or for smaller groups, the Old Dairy; a compact, light space with a log burner for winter months and a private outdoor courtyard for warmer months. The pristine ground provide numerous opportunities for outdoor activities and social-team building exercises. Whatever the weather, our diverse venue means we've got you covered, offering a variety of spaces which can be tailored to your needs.





## THE BARN

UP TO 150 SEATED AND 200 STANDING

The heart of the venue makes host to larger events given its open and dynamic space. The Barn is ideal for a variety of events including lunches, seminars, workshops and parties.

## THE PHEASANTRY, ORANGERY & GARDENS

30-50 GUESTS

Adjoined areas encourage a natural flow between spaces, allowing attendees to be provided with ample space and access to the landscaped gardens which include sheltered areas.

## THE OLD DAIRY

2-15 GUESTS

With a self-serve kitchenette and log burner, plus a private courtyard, the Old Dairy is an intimate space to host smaller meetings or the perfect break-out space for a larger event.



## ENTIRE VENUE

UP TO 150 GUESTS SEATED  
AND 200 STANDING

Make the most of what Gate Street has to offer and hire the entire venue exclusively for your event.





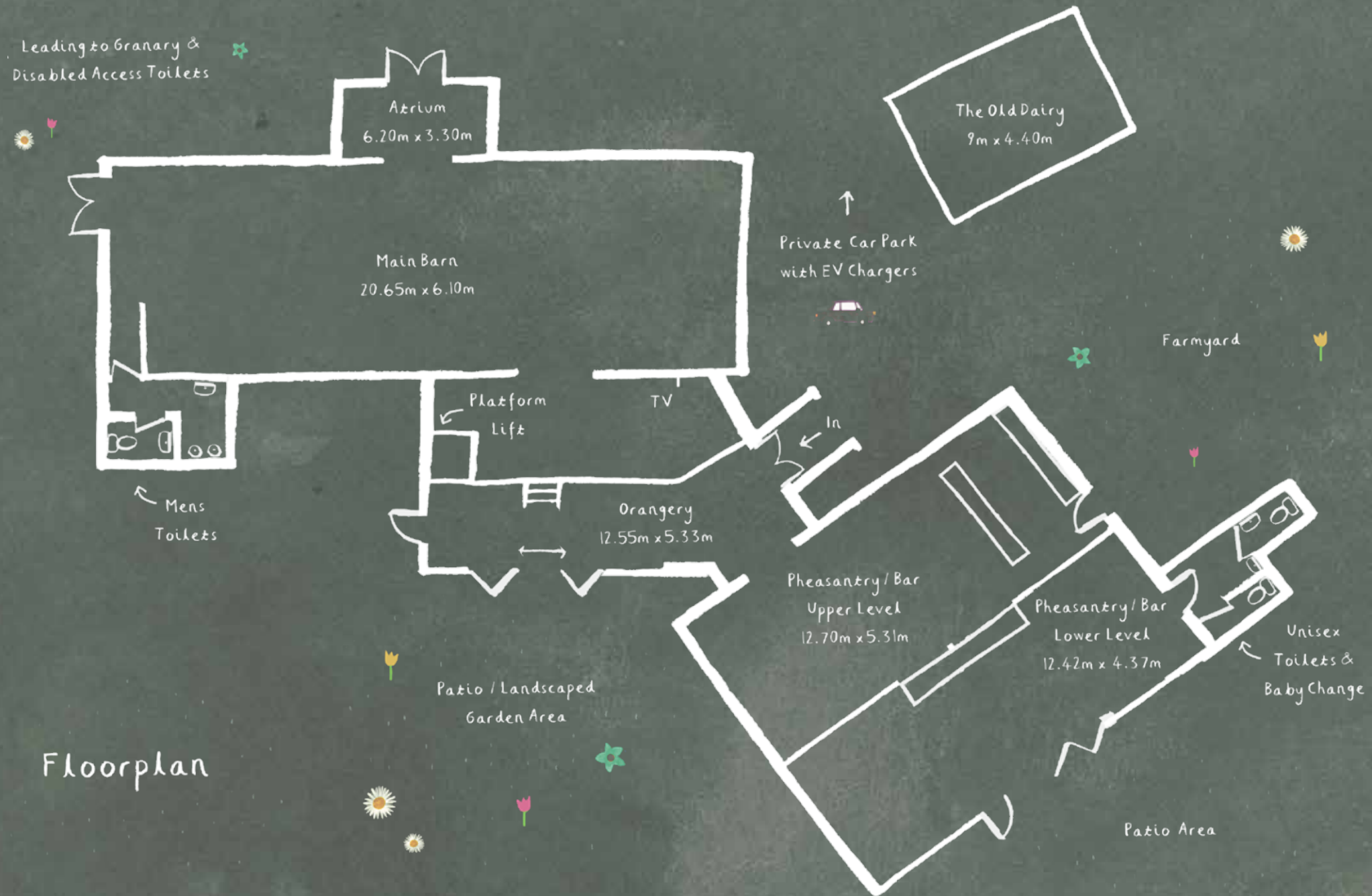

Floorplan





# OUR PACKAGES

CHOOSE FROM ONE OF OUR FOUR CORPORATE PACKAGES

## Co-work in Country Comforts

*Escape the city office for the ultimate countryside workspace*

Room Hire £350.00 inc. VAT

- Old Dairy – Day Hire
- Access 9am-5pm
- Capacity – Up To 15 Delegates
- Complimentary Wi-Fi
- On-Site Parking
- Self Catered (Please enquire if you require catering)
- Tea & Coffee
- Dedicated Events Co-ordinator to assist you on the day

## Bond! Build! Brunch!

*Focus on fostering team unity in the tranquil Surrey Hills*

Delegate Rate – From £59.50pp inc. VAT

- Pheasantry, Orangery & Gardens – Day Hire
- Access 9am-5pm
- Capacity – 20-40 Delegates
- Complimentary Wi-Fi
- On-Site Parking
- Surrey Platter Lunch - inc Soft Drink Options
- Tea & Coffee
- Dedicated Events Co-ordinator to assist you on the day

## Let's Get Down to Business...

*Tailored for larger groups seeking  
a change of pace and scenery in an idyllic location*

Delegate Rate – From £126.00pp inc. VAT

- Full Venue – Day Hire
- Access 9am-5pm
- Capacity – 50-150 Delegates
- Complimentary Wi-Fi
- On-Site Parking
- Breakfast
- Two Course Lunch – inc Soft Drink Options
- Tea & Coffee
- Dedicated Events Co-ordinator to assist you on the day

## Party Time!

*From Summer BBQs to Christmas Parties,  
sign-off and celebrate in style!*

Delegate Rate – From £65.00pp inc. VAT

- Evening Party
- Access 6pm-12pm
- Capacity – 80-200 Delegates
- Complimentary Wi-Fi
- On-Site Parking
- Welcome Drink
- Evening Party Food
- DJ
- Bar Service
- Dedicated Events Co-ordinator to assist you on the evening



# OUR ACCOMMODATION

## INDULGE IN OUR LUXURIOUS ONSITE ACCOMMODATION

Experience traditional country living with all the added luxuries to make for a dreamy stay. Steps away from the heart of the venue, our six unique onsite units offer a tranquil environment for you to relax in. From the Farmhouse to the Shepherd's Hut, we provide and cater for all your wants and needs to ensure your time at Gate Street is unforgettable.







## THE FARMHOUSE

🛏 14   👥 7   🚿 6

Gate Street Farmhouse is our country gem with open fires for Winter and a heated swimming pool for Summer. Enjoy your morning coffee beneath the pergola, with stunning views of the garden, whilst our chef prepares a traditional cooked breakfast for you.



## THE POOL HOUSE

🛏 1   👥 2   🚿 1

The Pool House is the newest addition to our onsite accommodation, located a few short steps away from the Farmhouse pool and landscaped gardens. Its self-contained kitchen is equipped with tea and coffee making facilities, a small fridge, induction hob and preparation space.



## THE SHEPHERD'S HUT

🛏 1   👥 2   🚿 1

The Shepherd's Hut is our desirable glamping option which makes for the ideal countryside getaway. Keep warm in the Winter months with the built in log burner and stargaze on the patio on a summer evening. A private bathroom is situated steps away, adjacent to the Secret Garden.



## THE STABLE FLAT

🛏 2   👥 6   🚿 1

The Stable Flat is comprised of two double bedrooms with the option of setting up a sofa bed in the living area. A private garden offers stunning views of the Surrey Hills and is a perfect spot for an al fresco breakfast.



## THE BEECH HUT

🛏 1   👥 2   🚿 1

Situated beneath a large Beech Tree, our Beech Hut sits in a secluded field near The Farmhouse grounds. The hut is equipped with an en-suite, kitchenette area, log burner and folding bed above the dining space.



## THE HAYLOFT

🛏 1   👥 2   🚿 1

The secluded Hayloft is our converted wood shed which has been transformed into a cosy haven for two. The Hayloft boasts original wooden beams and is equipped with a small kitchenette and ensuite.



# FILMING AT GATE STREET

## A DIVERSE CHOICE OF FILMING LOCATIONS

The Surrey Hills is no stranger to the big screen and is recognisable from films including The Holiday, Bridget Jones, Gladiator and Skyfall. Located within an hour's drive from Central London, Gate Street's diverse landscape and architecture makes it a versatile film set. We have multiple parking sites and our idyllic surroundings are second to none.



## FILM LOCATIONS: LANDSCAPES & FARMLAND

All filming requirements vary and therefore we understand the high amount of flexibility that needs to be offered. We encourage arranging a visit with a member of our dedicated team so we can provide a tour of the 160 acres Gate Street boasts.



ORIGINAL OAK-BEAMED BARN



BUILDINGS & ACCOMMODATION



LIVESTOCK & WILDLIFE



WOODLAND & TRACKS



# YOUR EVENT

## PERFECT FOR ANY OCCASION

With years of experience, our dedicated team are here to help every step of the way to ensure your experience at Gate Street is memorable. Our picture-perfect venue will have all your guests enthralled and planning their next visit. We are here to help every step of the way and we have a number of recommended suppliers who will ensure your day is exactly as you envisioned it to be. From birthdays to anniversaries, Summer BBQs to engagement parties; we can guarantee your special day will be one to remember. Work with one of our recommended caterers to design a bespoke menu for your event - a traditional sit down meal or an afternoon tea are popular options. Our grounds and event spaces can be decorated as per your requirements to personalise your celebration.





## OUR KEY FEATURES

To help create your bespoke day, we have included some details below which ensure your event is seamless and catered for:

- Up to 200 attendees
- Multiple flexible meeting areas
- Tables & Chairs included
- PA system in Barn
- Option for Screen hire
- Fully licensed bar
- On site accommodation
- Unlimited parking
- EV chargers
- Excellent Wifi
- Variety of catering options to accommodate requirements
- Multitude of wellness activities to balance corporate day (yoga, woodland bathing, etc)
- Variety of team building activities (archery, go Karting, Axe throwing, farm experiences, etc)



CHARITY  
EVENTS



COOKERY  
DEMONSTRATIONS



SEASONAL  
WORKSHOPS



AL FRESCO  
LUNCHES



EXHIBITIONS  
& PRODUCT LAUNCHES



CELEBRATORY  
OCCASIONS



# YOUR WELLNESS

## TAKE TIME TO MAKE YOUR SOUL HAPPY

Gate Street is the ideal location for you to escape from the day-to-day and focus on your wellness. From wild bathing to indoor/outdoor yoga spaces, exclusively hire the venue to reconnect yourself with nature. Hosting your event with us means we've got you covered and will be with you every step of the way to ensure your event is designed to your unique requirements. Indulge in the natural surroundings and enjoy the luxury accommodation to make your stay an oasis of relaxation.







## WELLNESS FEATURES

Choose from a variety of activities to curate your day. We have included some inspiration below:

- Wild bathing at Wintershall Lakes
- Indoor/outdoor yoga and pilates spaces
- Mindfulness and meditation
- Ceremonial Cacao
- Solestry
- Woodland Sound bathing
- Massages and reflexology
- Fermenting workshops
- Nutritional services
- Detox cleanses





# TEAM BUILDING

## THE PERFECT OUTDOOR AND INDOOR LOCATIONS

Using our recommended suppliers, arrange a corporate day for you and your team. From clay pigeon shooting to puzzle-solving tasks, Gate Street has a plethora of spaces, indoor & outdoor, for you to utilise in a unique setting. Outdoor activities, such as golf buggying and archery, can take place on the open grounds that surround the heart of the venue. If the weather is unkind, ample space for indoor activities such as cocktail making and cookery courses can be located in the venue.







COUNTRYSIDE WALKS



CHALLENGES & GAMES



CLAY PIGEON SHOOTING



OFF-ROAD BUGGIES



COCKTAIL MAKING



DEMONSTRATIONS & LEARNING

## TEAM BUILDING ACTIVITIES

Choose one of the bespoke packages curated by Gate Street to offer your team a variety of entertainments to keep your day active and fun. Alternatively, arrange activities via one of our recommended, professional team-building experts.



# HOW TO FIND US

RURAL LOCATION ON A PRIVATE ESTATE  
CLOSE TO INTERNATIONAL AIRPORTS,  
MAINLINE RAIL, THE A3 AND M25

- DO NOT RELY ON SATNAV - many systems take you on a circuitous route!
- Although our postal address is Bramley, the turning off the A281 is approx 2 miles south of Bramley heading towards Horsham.
- Please drive slowly along our beautiful country lanes and give way to cars, cyclists, horses and pedestrians.



LOCAL MAP



REGIONAL MAP

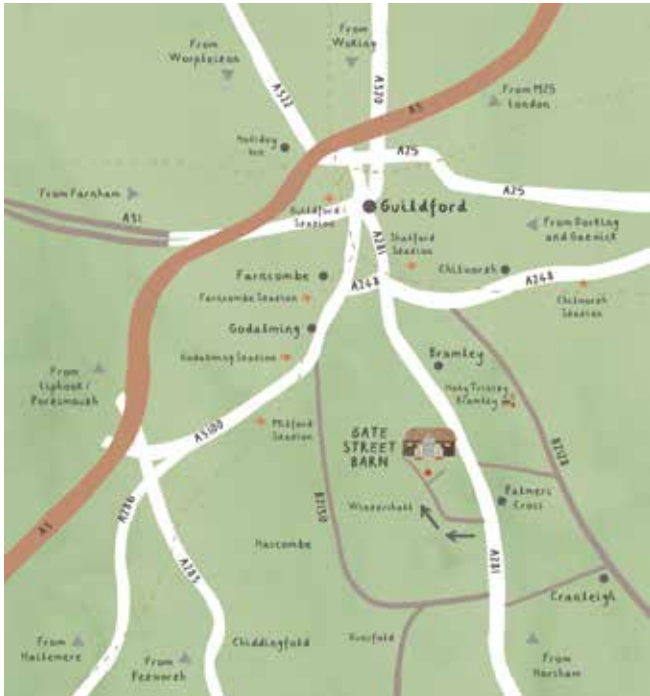

AREA MAP

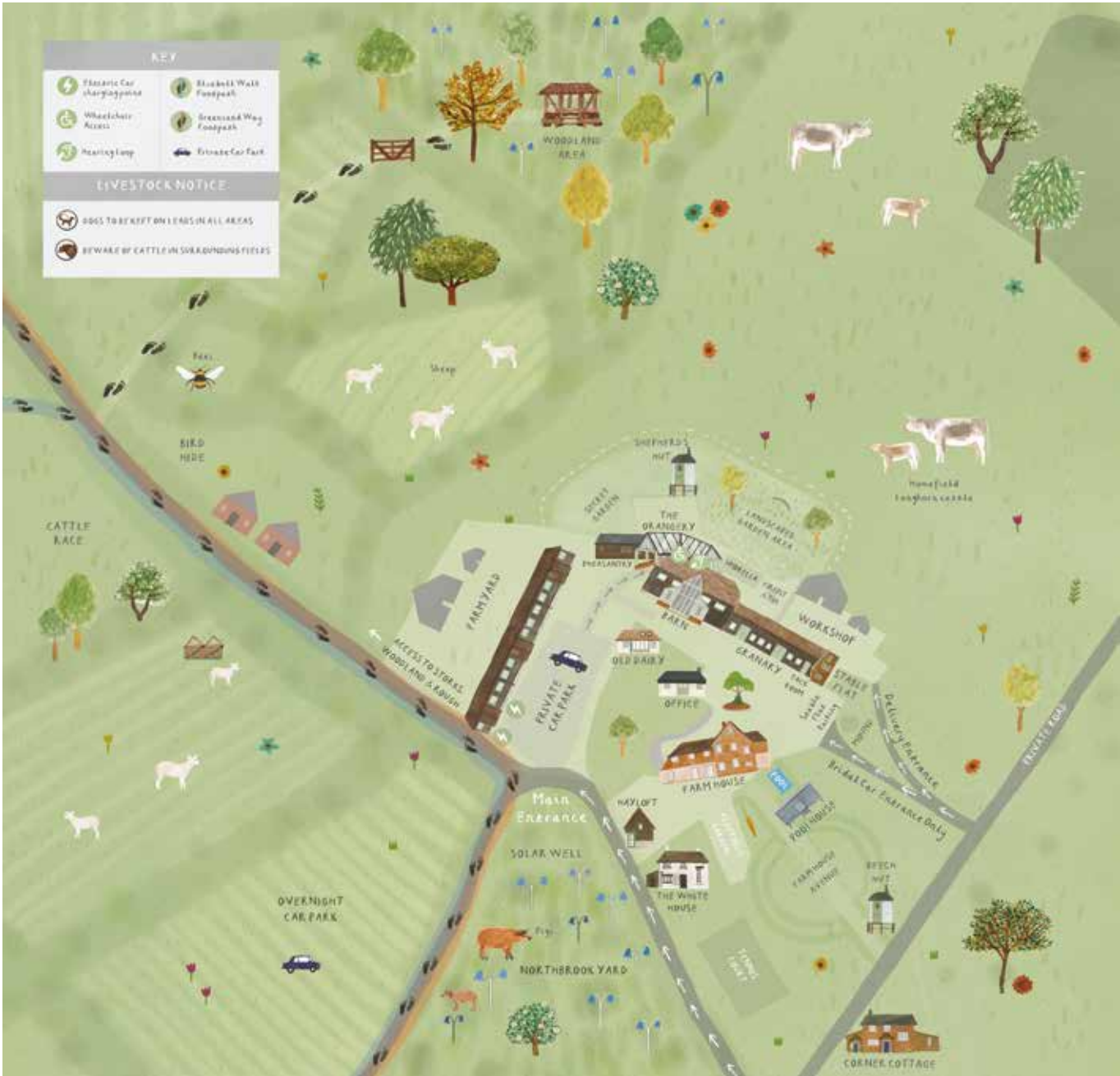

SITE PLAN







# GATE STREET

A UNIQUE VENUE NESTLED IN THE SURREY HILLS

Bramley Guildford Surrey GU5 0LR

01483 894362

[info@gatestreet.co.uk](mailto:info@gatestreet.co.uk) [www.gatestreet.co.uk](http://www.gatestreet.co.uk)

   [gatestreetvenue](#)

